

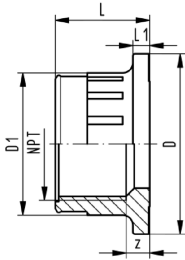

SYGEF Standard
Valve end 546 Pro and 543 Pro (G53)
With threaded socket NPT

Model:

- Material: PVDF
- Connection to plastic thread only
- Do not use thread sealing pastes that are harmful to PVDF



| PN (bar) | NPT (inch) | Code | Weight (kg) | D (mm) | D1 (mm) | D2 (mm) | L (mm) | L1 (mm) | z (mm) |
|-------------|---------------|--------------------|----------------|-----------|------------|------------|-----------|------------|-----------|
| 10 | 3/8 | 175 483 058 | 0.010 | 38 | 26 | 14 | 20 | 4 | 6 |
| 10 | 1/2 | 175 483 059 | 0.017 | 38 | 33 | 16 | 21 | 4 | 4 |
| 10 | 3/4 | 175 483 060 | 0.022 | 44 | 39 | 20 | 23 | 5 | 5 |
| 10 | 1 | 175 483 061 | 0.040 | 53 | 47 | 26 | 28 | 5 | 6 |
| 10 | 1 1/4 | 175 483 062 | 0.070 | 65 | 55 | 33 | 31 | 5 | 8 |
| 10 | 1 1/2 | 175 483 063 | 0.100 | 77 | 65 | 41 | 34 | 6 | 11 |
| 10 | 2 | 175 483 064 | 0.180 | 99 | 77 | 51 | 41 | 7 | 17 |

The technical data are not binding. They neither constitute expressly warranted characteristics nor guaranteed properties nor a guaranteed durability. They are subject to modification. Our General Terms of Sale apply.

Georg Fischer Piping Systems Ltd, Postfach, CH-8201 Schaffhausen/Switzerland Phone +41 -(0)52-631 1111 e-mail:
 info.ps@georgfischer.com Internet: <http://www.gfps.com>