

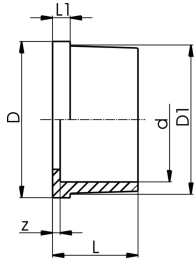

**PROGEF Standard union end  
PN10**

**Model:**

- Material: PP-H
- Fusion socket metric



d (mm)	SDR	FM	Code	Weight (kg)	L (mm)	L1 (mm)	D (mm)	D1 (mm)	z (mm)
16			<b>727 500 105</b>	0.003	18	4	24	22	3
20			<b>727 500 106</b>	0.006	19	5	30	28	3
25			<b>727 500 107</b>	0.011	21	5	39	36	3
32			<b>727 500 108</b>	0.014	23	6	45	42	3
40			<b>727 500 109</b>	0.025	25	6	57	53	3
50			<b>727 500 110</b>	0.025	28	7	63	59	3
63			<b>727 500 111</b>	0.043	32	8	79	74	3
75	11	IR	<b>727 500 312</b>	0.090	36	10	103	91	3
90	11	IR	<b>727 500 313</b>	0.130	42	11	123	108	5
110	11	IR	<b>727 500 314</b>	0.220	49	12	148	131	6

The technical data are not binding. They neither constitute expressly warranted characteristics nor guaranteed properties nor a guaranteed durability. They are subject to modification. Our General Terms of Sale apply.

Georg Fischer Piping Systems Ltd, Postfach, CH-8201 Schaffhausen/Switzerland Phone +41 -(0)52-631 1111 e-mail:  
info.ps@georgfischer.com Internet: <http://www.gfps.com>