

Diaphragm valve type 517 PVC-U With backing flanges PVC-U metric/BS

Model:

- Double flow rate compared to predecessor
- One housing nut replaces four screws
- Handwheel with built-in locking mechanism
- Flat sealing faces
- Overall length EN 558
- Connecting dimension: ISO 7005 PN 10, EN 1092 PN 10, DIN 2501 PN 10, BS 4504 PN 10

Option:

- Individual configuration of the valve
- Self adjusting multifunctional module with integrated limit switches

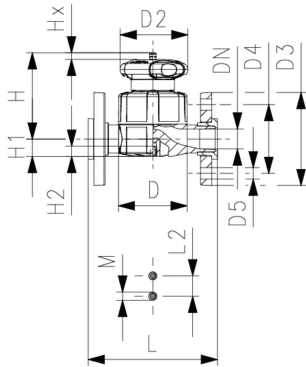

d (mm)	DN (mm)	Size (inch)	PN (bar)	kv-value ($\Delta p=1$ bar) (l/min)	NBR Code	SP Weight (kg)	EPDM Code	SP Weight (kg)		
20	15	½	10	125	161 517 002	1	0.493	161 517 012	1	0.395
25	20	¾	10	271	161 517 003	1	0.661	161 517 013	1	0.558
32	25	1	10	481	161 517 004	1	1.344	161 517 014	1	0.887
40	32	1 ¼	10	759	161 517 005	1	1.352	161 517 015	1	1.238
50	40	1 ½	10	1263	161 517 006	1	2.868	161 517 016	1	1.962
63	50	2	10	1728	161 517 007	1	3.789	161 517 017	1	2.893

d (mm)	PTFE/ EPDM* Code	SP Weight (kg)	FKM Code	SP Weight (kg)		
20	161 517 032	1	0.503	161 517 062	1	0.493
25	161 517 033	1	0.672	161 517 063	1	0.661
32	161 517 034	1	1.364	161 517 064	1	0.895
40	161 517 035	1	1.247	161 517 065	1	1.352
50	161 517 036	1	1.992	161 517 066	1	2.868
63	161 517 037	1	2.939	161 517 067	1	2.943

d (mm)	D (mm)	D2 (mm)	D3 (mm)	D4 (mm)	D5 (mm)	H (mm)	H1 (mm)	H2 (mm)	L (mm)	L2 (mm)	M	Lift = Hx (mm)	closest inch (inch)
20	65	65	95	65	14	73	14	12	130	25	M6	7	½
25	80	65	105	75	14	81	18	12	150	25	M6	10	¾
32	88	87	115	85	14	107	22	12	160	25	M6	13	1
40	101	87	140	100	18	115	26	15	180	45	M8	15	1 ¼
50	117	135	150	110	18	148	32	15	200	45	M8	19	1 ½
63	144	135	165	125	18	166	39	15	230	45	M8	25	2

The technical data are not binding. They neither constitute expressly warranted characteristics nor guaranteed properties nor a guaranteed durability. They are subject to modification. Our General Terms of Sale apply.

Georg Fischer Piping Systems Ltd, Postfach, CH-8201 Schaffhausen/Switzerland

Phone +41 -(0)52-631 1111

e-mail: info.ps@georgfischer.com

Internet: <http://www.gfps.com>