

Data sheet

valid from: 6/14/23



PROGEF Standard Elbow 90° SDR11/PN10

Model:

- Material: PP-H
- Conventional butt-welding according to DVS 2207
- IR = Infrared welding compatible

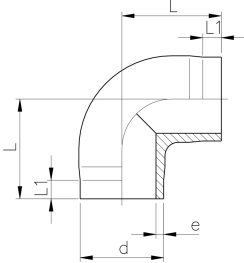

d (mm)	SDR	PN (bar)	FM	Code	Weight (kg)	L (mm)	L1 (mm)	e (mm)
20	11	10	IR	727 108 506	0.008	38	25	1.9
25	11	10	IR	727 108 507	0.012	42	26	2.3
32	11	10	IR	727 108 508	0.022	46	27	2.9
40	11	10	IR	727 108 509	0.045	51	22	3.7
50	11	10	IR	727 108 510	0.080	58	23	4.6
63	11	10	IR	727 108 511	0.138	66	21	5.8

The technical data are not binding. They neither constitute expressly warranted characteristics nor guaranteed properties nor a guaranteed durability. They are subject to modification. Our General Terms of Sale apply.

Georg Fischer Piping Systems Ltd, Postfach, CH-8201 Schaffhausen/Switzerland

Phone +41 -(0)52-631 1111

e-mail: info.ps@georgfischer.com

Internet: <http://www.gfps.com>