



Laboratory Ball Valve Type 522 PVC-U
With female thread-male thread

Model:

- Disconnection one end only
- Ball seal PTFE

Following connections/parts are included for every valve:

- Hose Nozzle
- Blind plug
- Double nipple
- Clip tie
- Locking and metering ring
- 2 O-rings

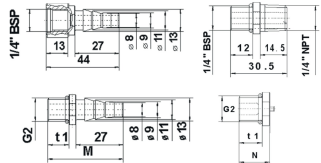
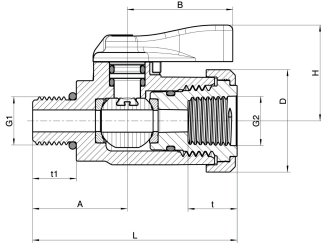
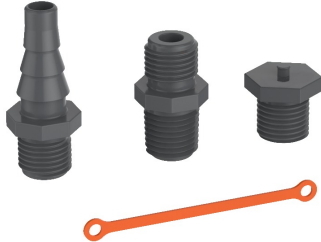

d (mm)	DN (mm)	Size (inch)	PN (bar)	EPDM Code	SP	Weight (kg)	FKM Code
10	6	1/8	10	161 522 060	1	0.050	161 522 070
10	6	1/8	10	161 522 080	1	0.050	
10	6	1/8	10	161 522 160	1	0.050	161 522 170

d (mm)	G1 (mm)	G2 (mm)	A (mm)	B (mm)	D (mm)	H (mm)	L (mm)	t (mm)	t1 (mm)
10	1/4" BSP	1/4" BSP	26.0	28.2	28	25.5	56.0	13.5	12
10	3/8" BSP	1/4" BSP	26.0	28.2	28	25.5	56.0	13.5	12
10	1/4" NPT	1/4" NPT	28.5	29.0	28	26.5	58.5	13.5	14.5

The technical data are not binding. They neither constitute expressly warranted characteristics nor guaranteed properties nor a guaranteed durability. They are subject to modification. Our General Terms of Sale apply.

Georg Fischer Piping Systems Ltd, Postfach, CH-8201 Schaffhausen/Switzerland Phone +41 -(0)52-631 1111 e-mail: info.ps@georgfischer.com Internet: <http://www.gfps.com>