

**Type 515 Diaphragm Valve PROGEF Standard PP**  
Butt fusion spigots SDR11 metric

**Model:**

- Overall length EN 558
- One housing nut replaces four screws
- Handwheel with built-in locking mechanism
- Double flow rate compared to predecessor
- Material: PP-H

Self adjusting multifunctional module with integrated limit switches  
Individual configuration of the valve (see diagram)

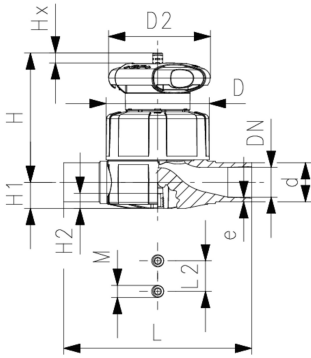

d (mm)	PN (bar)	Valve Tag 1	EPDM Code	PTFE/EPDM Code
20	10	DA-26	167 515 112	167 515 132
25	10	DA-26	167 515 113	167 515 133
32	10	DA-26	167 515 114	167 515 134
50	10	DA-26	167 515 116	167 515 136
63	10	DA-26	167 515 117	167 515 137

d (mm)	D (mm)	D2 (mm)	H (mm)	H1 (mm)	H2 (mm)	L (mm)	L2 (mm)	M	e (mm)	Lift = Hx (mm)	closest inch (inch)
20	65	65	73	14	12	124	25	M6	2	7	½
25	80	65	81	18	12	144	25	M6	2	10	¾
32	88	87	107	22	12	155	25	M6	3	13	1
50	117	135	148	32	15	193	45	M8	5	19	1 ½
63	144	135	166	39	15	223	45	M8	6	25	2

The technical data are not binding. They neither constitute expressly warranted characteristics nor guaranteed properties nor a guaranteed durability. They are subject to modification. Our General Terms of Sale apply.

Georg Fischer Piping Systems Ltd, Postfach, CH-8201 Schaffhausen/Switzerland  
Phone +41 -(0)52-631 1111  
e-mail: info.ps@georgfischer.com  
Internet: http://www.gfps.com