

# Data sheet

valid from: 9/26/17

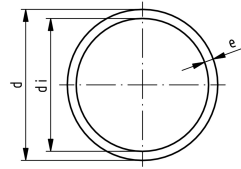

## Pipe ABS metric Nominal pressure PN10 (at 20°C)

### Model:

- Colour: RAL 7001, gravel grey
- Pipe length: 5m, with plain ends
- Minimum order quantity: 1 length

d (mm)	PN (bar)	d (inch)	Code	SP	Weight (kg/m)	e (mm)	di (mm)	closest inch (inch)	Copper size (inch)
32	10		<b>169 017 083</b>	25	0.213	1.9	28.2	1	1 1/8
40	10		<b>169 017 084</b>	25	0.337	2.4	35.2	1 1/4	1 3/8
50	10		<b>169 017 085</b>	25	0.526	3.0	44.0	1 1/2	1 5/8
63	10		<b>169 017 086</b>	15	0.839	3.8	55.4	2	2 1/8
75	10	2 1/2	<b>169 017 087</b>	10	1.183	4.5	66.0	2 1/2	2 3/8
90	10		<b>169 017 088</b>	5	1.704	5.4	79.2	3	3 1/8
110	10		<b>169 017 089</b>	5	2.546	6.6	96.8	4	4 1/8
140	10	5	<b>169 017 091</b>	0	4.489	8.3	123.4	5	5 1/8
160	10		<b>169 017 092</b>	0	5.856	9.5	141.0	6	6
200	10		<b>169 017 093</b>	5	9.133	12.3	175.4	8	8
225	10		<b>169 017 094</b>	5	11.605	13.9	197.2	9	9

The technical data are not binding. They neither constitute expressly warranted characteristics nor guaranteed properties nor a guaranteed durability. They are subject to modification. Our General Terms of Sale apply.

Georg Fischer Piping Systems Ltd, Postfach, CH-8201 Schaffhausen/Switzerland

Phone +41 -(0)52-631 1111

e-mail: [info.ps@georgfischer.com](mailto:info.ps@georgfischer.com)

Internet: <http://www.gfps.com>