

PROGEF Standard Diaphragm valve type 515 With socket fusion spigots metric

Model:

- Material: PP-H
- Double flow rate compared to predecessor
- One housing nut replaces four screws
- Handwheel with built-in locking mechanism
- Overall length EN 558

Option:

- Individual configuration of the valve
 - Self adjusting multifunctional module with integrated limit switches
- * O-Ring material: FKM

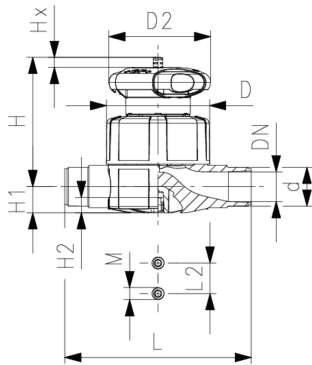

d (mm)	DN (mm)	Size (inch)	PN (bar)	kv-value ($\Delta p=1$ bar) (L/min)	NBR Code	EPDM Code	GP
20	15	½	10	125	167 515 002	167 515 012	10
25	20	¾	10	271	167 515 003	167 515 013	6
32	25	1	10	481	167 515 004	167 515 014	6
40	32	1 ¼	10	759	167 515 005	167 515 015	6
50	40	1 ½	10	1263	167 515 006	167 515 016	8
63	50	2	10	1728	167 515 007	167 515 017	

d (mm)	PTFE/ EPDM* Code	FKM Code	Weight (kg)
20	167 515 032	167 515 062	0.298
25	167 515 033	167 515 063	0.293
32	167 515 034	167 515 064	0.950
40	167 515 035	167 515 065	1.108
50	167 515 036	167 515 066	2.057
63	167 515 037	167 515 067	2.604

d (mm)	D (mm)	D2 (mm)	H (mm)	H1 (mm)	H2 (mm)	L (mm)	L2 (mm)	M	e (mm)	Lift = Hx (mm)	closest inch (inch)
20	65	65	73	14	12	124	25	M6	1.9	7	½
25	80	65	81	18	12	144	25	M6	2.3	10	¾
32	88	87	107	22	12	154	25	M6	2.9	13	1
40	101	87	115	26	15	174	45	M8	3.7	15	1 ¼
50	117	135	148	32	15	194	45	M8	4.6	19	1 ½
63	144	135	166	39	15	223	45	M8	5.8	25	2

The technical data are not binding. They neither constitute expressly warranted characteristics nor guaranteed properties nor a guaranteed durability. They are subject to modification. Our General Terms of Sale apply.

Georg Fischer Piping Systems Ltd, Postfach, CH-8201 Schaffhausen/Switzerland Phone +41 -(0)52-631 1111 e-mail: info.ps@georgfischer.com Internet: <http://www.gfps.com>