

DN10/15 - 50

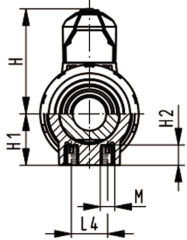
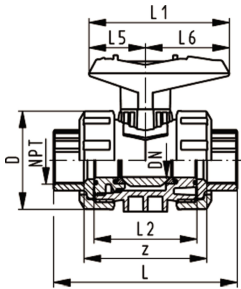

**SYGEF Standard  
Ball valve type 546  
With mounting inserts  
With threaded sockets NPT**

**Model:**

- Material: PVDF
- For easy installation and removal
- Ball seals PTFE
- Integrated stainless steel mounting inserts
- z-dimension, valve end and union nut are not compatible with type 346

**Option:**

- Individual configuration of the valve (see diagram)
- Multifunctional module with integrated limit switches
- Pneumatic or electric actuators from +GF+

NPT (inch)	DN (mm)	PN (bar)	kv-value ( $\Delta p=1$ bar) (L/min)	FKM Code	Weight (kg)
3/8	10	10	71	<b>175 546 331</b>	0.205
1/2	15	10	185	<b>175 546 332</b>	0.205
3/4	20	10	350	<b>175 546 333</b>	0.325
1	25	10	700	<b>175 546 334</b>	0.490
1 1/4	32	10	1000	<b>175 546 335</b>	0.820
1 1/2	40	10	1600	<b>175 546 336</b>	1.135
2	50	10	3100	<b>175 546 337</b>	2.150

NPT (inch)	D (mm)	H (mm)	H1 (mm)	H2 (mm)	L (mm)	L1 (mm)	L2 (mm)	L4 (mm)	L5 (mm)	L6 (mm)	M	z (mm)
3/8	50	57	27	12	96	77	56	25	32	45	M6	69
1/2	50	57	27	12	99	77	56	25	32	45	M6	64
3/4	58	67	30	12	111	97	65	25	39	58	M6	76
1	68	73	36	12	127	97	71	25	39	58	M6	83
1 1/4	84	90	44	15	146	128	85	45	54	74	M8	101
1 1/2	97	97	51	15	157	128	89	45	54	74	M8	111
2	124	116	64	15	183	152	101	45	66	87	M8	135

The technical data are not binding. They neither constitute expressly warranted characteristics nor guaranteed properties nor a guaranteed durability. They are subject to modification. Our General Terms of Sale apply.

Georg Fischer Piping Systems Ltd, Postfach, CH-8201 Schaffhausen/Switzerland

Phone +41 -(0)52-631 1111

e-mail: [info.ps@georgfischer.com](mailto:info.ps@georgfischer.com)

Internet: <http://www.gfps.com>