

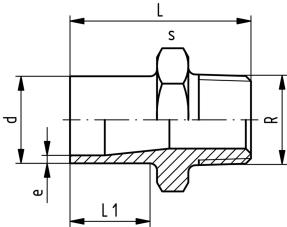

**PROGEF Standard Adaptor nipple**  
Metric R SDR11 (PN10)

**Model:**

- Material: PP-H
- With butt fusion spigot and BSP tapered male thread
- Do not use thread sealing pastes that are harmful to PP
- Install with low mechanical stress and avoid large cyclic temperature changes



d (mm)	Thread Type	Size (inch)	PN (bar)	SDR	FM	Code	SP	Weight (kg)	L (mm)	L1 (mm)	s (mm)	e (mm)
20	R	½	10	11	IR	<b>727 910 556</b>	10	0.013	51	23	32	1.9
25	R	¾	10	11	IR	<b>727 910 557</b>	10	0.014	52	23	36	2.3
32	R	1	10	11	IR	<b>727 910 558</b>	10	0.027	55	23	46	2.9
40	R	1 ¼	10	11	IR	<b>727 910 559</b>	10	0.041	58	23	55	3.7
50	R	1 ½	10	11	IR	<b>727 910 560</b>	10	0.062	60	23	65	4.6
63	R	2	10	11	IR	<b>727 910 561</b>	5	0.096	67	26	80	5.8

The technical data are not binding. They neither constitute expressly warranted characteristics nor guaranteed properties nor a guaranteed durability. They are subject to modification. Our General Terms of Sale apply.

Georg Fischer Piping Systems Ltd, Postfach, CH-8201 Schaffhausen/Switzerland

Phone +41 -(0)52-631 1111

e-mail: [info.ps@georgfischer.com](mailto:info.ps@georgfischer.com)

Internet: <http://www.gfps.com>