

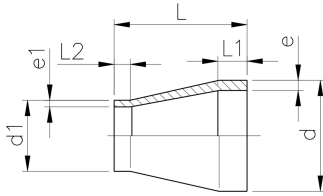

SYGEF Plus reducer
SDR21/PN16
High Purity clean-room product ISO Class 5 (100)

Model:

- Material: PVDF-HP



d (mm)	d1 (mm)	PN (bar)	FM	Code	Weight (kg)	L (mm)	L1 (mm)	L2 (mm)	e (mm)	e1 (mm)
25	20	16	BCF, IR	735 908 600	0.013	50	22	22	1.9	1.9
32	20	16	BCF, IR	735 908 602	0.018	50	22	22	2.4	1.9
32	25	16	BCF, IR	735 908 601	0.019	50	22	22	2.4	1.9
40	20	16	BCF, IR	735 908 605	0.025	58	22	24	2.4	1.9
40	25	16	BCF, IR	735 908 604	0.025	55	22	24	2.4	1.9
40	32	16	BCF, IR	735 908 603	0.029	55	22	24	2.4	2.4
50	25	16	BCF, IR	735 908 608	0.040	60	22	25	3.0	1.9
50	32	16	BCF, IR	735 908 607	0.044	60	22	25	3.0	2.4
50	40	16	BCF, IR	735 908 606	0.046	60	22	25	3.0	2.4
63	32	16	BCF, IR	735 908 611	0.059	65	22	25	3.0	2.4
63	40	16	BCF, IR	735 908 610	0.061	65	22	25	3.0	2.4
63	50	16	BCF, IR	735 908 609	0.070	65	22	25	3.0	3.0
75	40	16	BCF, IR	735 908 614	0.109	68	24	25	3.6	2.4
75	50	16	BCF, IR	735 908 613	0.091	65	24	25	3.6	3.0
75	63	16	BCF, IR	735 908 612	0.095	65	24	25	3.6	3.0
90	63	16	BCF, IR	735 908 616	0.164	75	25	30	4.3	3.0
90	75	16	BCF, IR	735 908 615	0.187	75	25	35	4.3	3.6
110	63	16	BCF, IR	735 908 619	0.239	90	30	30	5.3	3.0
110	75	16	BCF, IR	735 908 618	0.249	90	30	35	5.3	3.6
110	90	16	BCF, IR	735 908 617	0.266	90	30	35	5.3	4.3
140	110	16	IR	735 908 621	0.614	110	40	40	6.7	5.3
160	110	16	IR	735 908 623	0.706	120	40	40	7.7	5.3
160	140	16	IR	735 908 622	0.899	120	40	40	7.7	6.7
200	160	16	IR	735 908 624	1.474	145	40	35	9.6	7.7
225	110	16	IR	735 908 625	1.630	160	55	40	10.8	5.3
225	160	16	IR	735 908 626	1.762	160	55	28	10.8	7.7
225	200	16	IR	735 908 627	2.142	160	55	50	10.8	9.6

The technical data are not binding. They neither constitute expressly warranted characteristics nor guaranteed properties nor a guaranteed durability. They are subject to modification. Our General Terms of Sale apply.

Georg Fischer Piping Systems Ltd, Postfach, CH-8201 Schaffhausen/Switzerland

Phone +41 -(0)52-631 1111

e-mail: info.ps@georgfischer.com

Internet: <http://www.gfps.com>