

SYGEF Standard Diaphragm valve type 517 With backing flanges PP-V metric BS

Model:

- Material: PVDF
- Double flow rate compared to predecessor
- One housing nut replaces four screws
- Handwheel with built-in locking mechanism
- Joining faces flat/serrated
- Overall length EN 558
- Connecting dimension: ISO 7005 PN 10, EN 1092 PN 10, DIN 2501 PN 10, BS 4504 PN 10

Option:

- Individual configuration of the valve
- Self adjusting multifunctional module with integrated limit switches

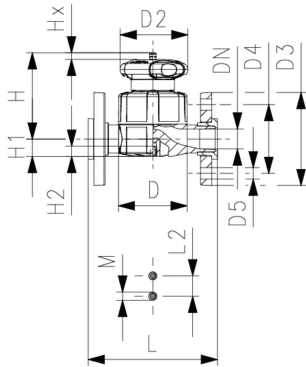

d (mm)	DN (mm)	Size (inch)	PN (bar)	kv-value ($\Delta p=1$ bar) (L/min)	PTFE/ EPDM* Code	Weight (kg)	PTFE/FKM* Code	Weight (kg)
20	15	½	10	125	185 517 132	0.586	185 517 152	0.586
25	20	¾	10	271	185 517 133	0.796	185 517 153	0.796
32	25	1	10	481	185 517 134	1.064	185 517 154	1.064
40	32	1 ¼	10	759	185 517 135	2.001	185 517 155	2.001
50	40	1 ½	10	1263	185 517 136	2.369	185 517 156	2.369
63	50	2	10	1728	185 517 137	3.586	185 517 157	3.586

D (mm)	D2 (mm)	D3 (mm)	D4 (mm)	D5 (mm)	H (mm)	H1 (mm)	H2 (mm)	L (mm)	L2 (mm)	M	Lift = Hx (mm)
65	65	95	65	14	73	14	12	130	25	M6	7
80	65	105	75	14	81	18	12	150	25	M6	10
88	87	115	85	14	107	22	12	160	25	M6	13
101	87	140	100	18	115	26	15	180	45	M8	15
117	135	150	110	18	148	32	15	200	45	M8	19
144	135	165	125	18	166	39	15	230	45	M8	25

The technical data are not binding. They neither constitute expressly warranted characteristics nor guaranteed properties nor a guaranteed durability. They are subject to modification. Our General Terms of Sale apply.

Georg Fischer Piping Systems Ltd, Postfach, CH-8201 Schaffhausen/Switzerland

Phone +41 -(0)52-631 1111

e-mail: info.ps@georgfischer.com

Internet: <http://www.gfps.com>