

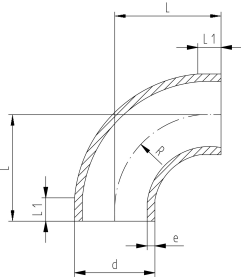

1



2



## PROGEF Standard Bend 90° SDR11/PN10

### Model:

- Material: PP-H
- Conventional butt-welding according to DVS 2207
- IR = Infrared welding compatible

\* Material: PP-R

d (mm)	SDR	PN (bar)	FM	Type	Code	Weight (kg)	L (mm)	L1 (mm)	R (mm)	e (mm)
20	11	10	IR	1	727 018 606	0.008	38	23	15.00	1.9
25	11	10	IR	1	727 018 607	0.013	42	23	19.00	2.3
32	11	10	IR	1	727 018 608	0.022	46	22	24.00	2.9
40	11	10	IR	1	727 018 609	0.040	51	21	30.00	3.7
50	11	10	IR	1	727 018 610	0.067	58	21	37.00	4.6
63	11	10	IR	1	727 018 611	0.117	66	21	45.00	5.8
75	11	10	IR	2	727 018 622	0.178	75	21	71.25	6.8
90	11	10	IR	2	727 018 623	0.308	90	22	85.50	8.2
110	11	10	IR	2	727 018 624	0.556	110	25	104.50	10.0
125	11	10	IR	2	727 018 615	0.818	125	28	116.00	11.4
140	11	10	IR	2	727 018 616	1.148	140	33	131.00	12.7
160	11	10	IR	2	727 018 617	1.699	160	33	151.00	14.6
180	11	10	IR	2	727 018 618	2.394	180	33	171.00	16.4
200	11	10	IR	2	727 018 619	3.264	200	33	190.00	18.2
225	11	10	IR	2	727 018 620	4.535	220	33	210.00	20.5
250	11	10	IR	1	727 018 521	6.351	256	48	232.00	22.7
280	11	10	IR	1	727 018 522	9.398	286	48	262.00	25.4
315	11	10	IR	1	727 018 523	12.959	321	48	297.00	28.6
*	355	11	10	2	727 018 524	16.400	345	70	330.00	32.2
*	400	11	10	2	727 018 525	22.220	365	70	350.00	36.3
*	450	11	10	2	727 018 526	32.560	425	70	400.00	40.9
*	500	11	10	2	727 018 527	44.840	470	90	445.00	45.4

The technical data are not binding. They neither constitute expressly warranted characteristics nor guaranteed properties nor a guaranteed durability. They are subject to modification. Our General Terms of Sale apply.

Georg Fischer Piping Systems Ltd, Postfach, CH-8201 Schaffhausen/Switzerland

Phone +41 -(0)52-631 1111

e-mail: [info.ps@georgfischer.com](mailto:info.ps@georgfischer.com)

Internet: <http://www.gfps.com>