

## PROGEF Standard Diaphragm valve type 517 With backing flanges PP-V metric/BS

### Model:

- Material: PP-H
- Double flow rate compared to predecessor
- One housing nut replaces four screws
- Handwheel with built-in locking mechanism
- Joining faces flat/serrated
- Overall length EN 558
- Connecting dimension: ISO 7005 PN 10, EN 1092 PN 10, DIN 2501 PN 10, BS 4504 PN 10

### Option:

- Individual configuration of the valve
- Self adjusting multifunctional module with integrated limit switches

\* O-Ring material: FKM

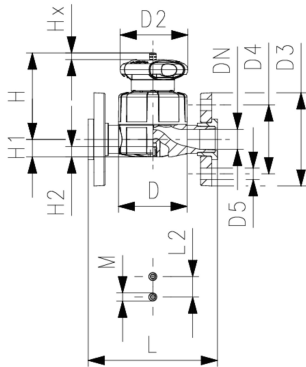

| d<br>(mm) | DN<br>(mm) | Size<br>(inch) | PN<br>(bar) | kv-value<br>( $\Delta p=1$ bar)<br>(L/min) |
|-----------|------------|----------------|-------------|--|
| 20        | 15         | ½              | 10          | 125  |
| 25        | 20         | ¾              | 10          | 271  |
| 32        | 25         | 1              | 10          | 481  |
| 40        | 32         | 1 ¼            | 10          | 759  |
| 50        | 40         | 1 ½            | 10          | 1263                                       |
| 63        | 50         | 2              | 10          | 1728                                       |

| d<br>(mm) | NBR<br>Code | EPDM<br>Code | PTFE/<br>EPDM*<br>Code | FKM<br>Code | Weight<br>(kg) |
|-----------|-------------|--------------|------------------------|-------------|----------------|
| 20        | 167 517 102 | 167 517 112  | 167 517 132            | 167 517 162 | 0.480          |
| 25        | 167 517 103 | 167 517 113  | 167 517 133            | 167 517 163 | 0.629          |
| 32        | 167 517 104 | 167 517 114  | 167 517 134            | 167 517 164 | 1.296          |
| 40        | 167 517 105 | 167 517 115  | 167 517 135            | 167 517 165 | 1.640          |
| 50        | 167 517 106 | 167 517 116  | 167 517 136            | 167 517 166 | 2.601          |
| 63        | 167 517 107 | 167 517 117  | 167 517 137            | 167 517 167 | 3.544          |

| d<br>(mm) | D<br>(mm) | D2<br>(mm) | D3<br>(mm) | D4<br>(mm) | D5<br>(mm) | H<br>(mm) | H1<br>(mm) | H2<br>(mm) | L<br>(mm) | L2<br>(mm) | M  | Lift =<br>Hx<br>(mm) | closest<br>inch<br>(inch) |
|-----------|-----------|------------|------------|------------|------------|-----------|------------|------------|-----------|------------|----|----------------------|---------------------------|
| 20        | 65        | 65         | 95         | 65         | 14         | 73        | 14         | 12         | 130       | 25         | M6 | 7                    | ½                         |
| 25        | 80        | 65         | 105        | 75         | 14         | 81        | 18         | 12         | 150       | 25         | M6 | 10                   | ¾                         |
| 32        | 88        | 87         | 115        | 85         | 14         | 107       | 22         | 12         | 160       | 25         | M6 | 13                   | 1                         |
| 40        | 101       | 87         | 140        | 100        | 18         | 115       | 26         | 15         | 180       | 45         | M8 | 15                   | 1 ¼                       |
| 50        | 117       | 135        | 150        | 110        | 18         | 148       | 32         | 15         | 200       | 45         | M8 | 19                   | 1 ½                       |
| 63        | 144       | 135        | 165        | 125        | 18         | 166       | 39         | 15         | 230       | 45         | M8 | 25                   | 2                         |

The technical data are not binding. They neither constitute expressly warranted characteristics nor guaranteed properties nor a guaranteed durability. They are subject to modification. Our General Terms of Sale apply.

Georg Fischer Piping Systems Ltd, Postfach, CH-8201 Schaffhausen/Switzerland Phone +41 -(0)52-631 1111 e-mail:  
info.ps@georgfischer.com Internet: <http://www.gfps.com>