

Data sheet

valid from: 7/27/23

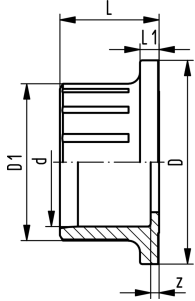
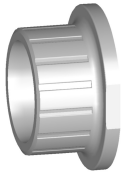

Valve end 546 Pro and 543 Pro PVC-C (G11) With solvent cement socket metric

d (mm)	PN (bar)	Code	Weight (kg)	z (mm)	D (mm)	L (mm)	D1 (mm)	L1 (mm)
16	16	163 481 275	0.009	4	38	18	23	4
20	16	163 481 276	0.011	4	38	20	27	4
25	16	163 481 277	0.016	4	44	23	33	5
32	16	163 481 278	0.025	4	53	26	41	5
40	16	163 481 279	0.043	5	65	31	51	5
50	16	163 481 280	0.072	3	77	34	62	6
63	16	163 481 281	0.128	3	99	41	77	7
75	16	163 481 282	0.249	4	125	49	92	9
90	16	163 481 283	0.416	5	150	57	110	10
110	16	163 481 284	0.705	5	180	69	134	11

The technical data are not binding. They neither constitute expressly warranted characteristics nor guaranteed properties nor a guaranteed durability. They are subject to modification. Our General Terms of Sale apply.

Georg Fischer Piping Systems Ltd, Postfach, CH-8201 Schaffhausen/Switzerland Phone +41 -(0)52-631 1111 e-mail:
info.ps@georgfischer.com Internet: <http://www.gfps.com>