

DN10/15 - 50

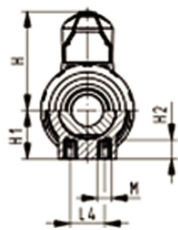
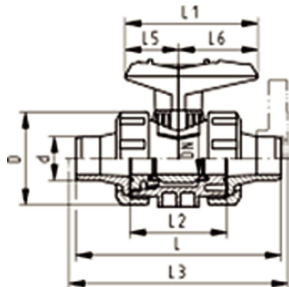

**SYGEF Standard**  
**Ball valve type 546**  
**With mounting inserts**  
**With socket fusion spigots metric**

**Model:**

- Material: PVDF
- For easy installation and removal
- Ball seals PTFE
- Integrated stainless steel mounting inserts
- z-dimension, valve end and union nut are **not compatible** with type 346 (DN10/15-50)

**Option:**

- Individual configuration of the valve (see diagram)
- Multifunctional module with integrated limit switches
- Pneumatic or electric actuators from GF

| d<br>(mm) | DN<br>(mm) | PN<br>(bar) | kv-value<br>( $\Delta p=1$ bar)<br>(L/min) | FKM<br>Code        | SP | Weight<br>(kg) |
|-----------|------------|-------------|--|--------------------|----|----------------|
| 16        | 10         | 16          | 71   | <b>175 546 051</b> | 1  | 0.200          |
| 20        | 15         | 16          | 185  | <b>175 546 052</b> | 1  | 0.205          |
| 25        | 20         | 16          | 350  | <b>175 546 053</b> | 1  | 0.310          |
| 32        | 25         | 16          | 700  | <b>175 546 054</b> | 1  | 0.460          |
| 40        | 32         | 16          | 1000                                       | <b>175 546 055</b> | 1  | 0.780          |
| 50        | 40         | 16          | 1600                                       | <b>175 546 056</b> | 1  | 1.110          |
| 63        | 50         | 16          | 3100                                       | <b>175 546 057</b> | 1  | 2.150          |

| d<br>(mm) | D<br>(mm) | H<br>(mm) | H1<br>(mm) | H2<br>(mm) | L<br>(mm) | L1<br>(mm) | L2<br>(mm) | L3<br>(mm) | L4<br>(mm) | L5<br>(mm) | L6<br>(mm) | M  | closest<br>inch<br>(inch) |
|-----------|-----------|-----------|------------|------------|-----------|------------|------------|------------|------------|------------|------------|----|---------------------------|
| 16        | 50        | 57        | 27         | 12         | 110       | 77         | 56         |            | 25         | 32         | 45         | M6 | 3/8                       |
| 20        | 50        | 57        | 27         | 12         | 120       | 77         | 56         | 130        | 25         | 32         | 45         | M6 | 1/2                       |
| 25        | 58        | 67        | 30         | 12         | 139       | 97         | 65         | 150        | 25         | 39         | 58         | M6 | 3/4                       |
| 32        | 68        | 73        | 36         | 12         | 150       | 97         | 71         | 160        | 25         | 39         | 58         | M6 | 1                         |
| 40        | 84        | 90        | 44         | 15         | 170       | 128        | 85         | 180        | 45         | 54         | 74         | M8 | 1 1/4                     |
| 50        | 97        | 97        | 51         | 15         | 190       | 128        | 89         | 200        | 45         | 54         | 74         | M8 | 1 1/2                     |
| 63        | 124       | 116       | 64         | 15         | 220       | 152        | 101        | 230        | 45         | 66         | 87         | M8 | 2                         |

The technical data are not binding. They neither constitute expressly warranted characteristics nor guaranteed properties nor a guaranteed durability. They are subject to modification. Our General Terms of Sale apply.

Georg Fischer Piping Systems Ltd, Postfach, CH-8201 Schaffhausen/Switzerland

Phone +41 -(0)52-631 1111

e-mail: [info.ps@georgfischer.com](mailto:info.ps@georgfischer.com)

Internet: <http://www.gfps.com>